

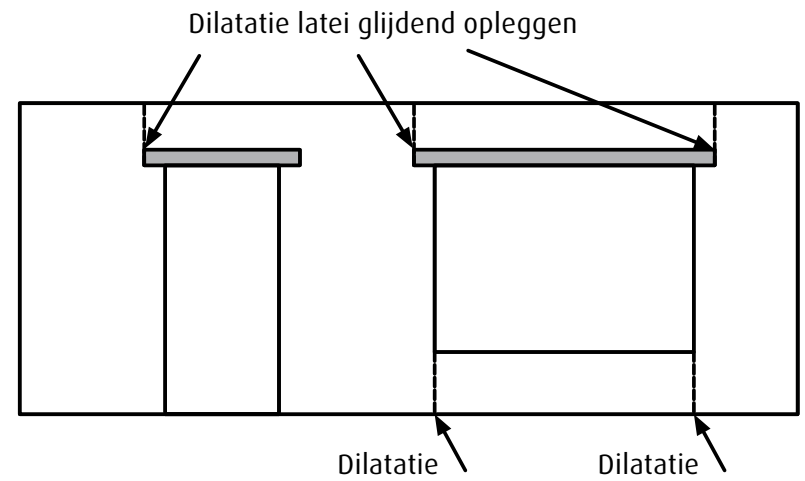

Dilataties

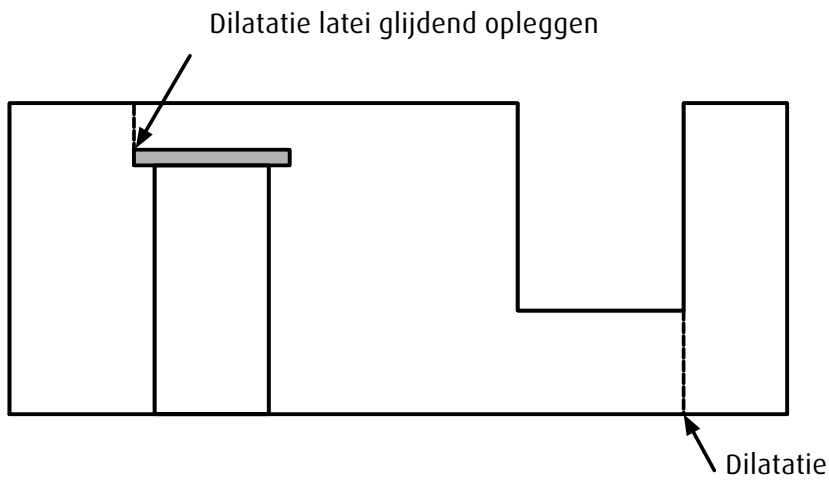

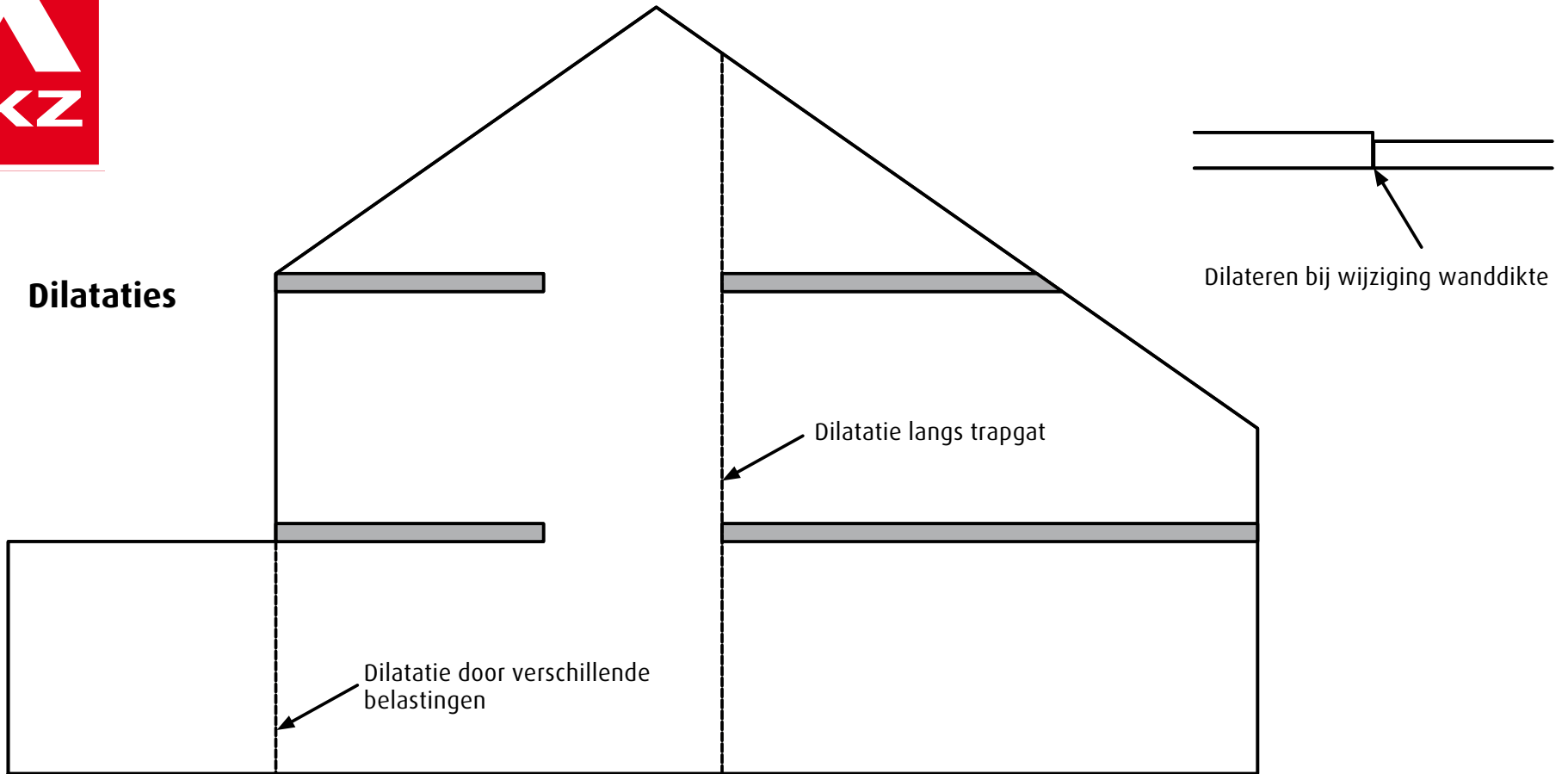

Dilatatiemogelijkheid vellingblokken

Bij niet dragende wanden folie met een minimale breedte toepassen van 90% van de wanddikte

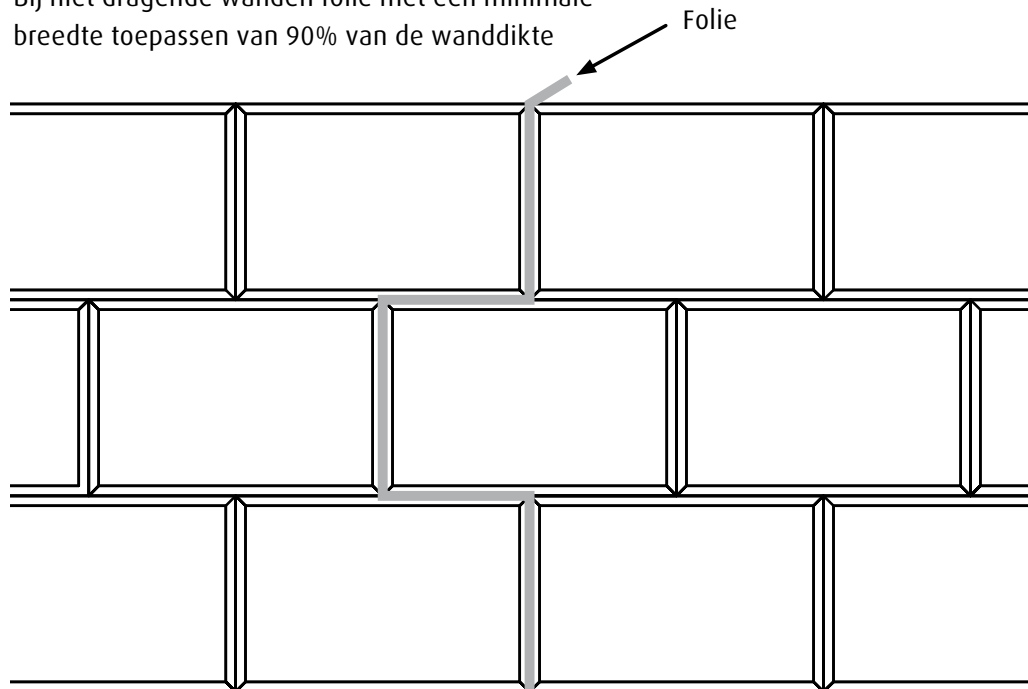

Afwerking gevulde dilatatievoeg

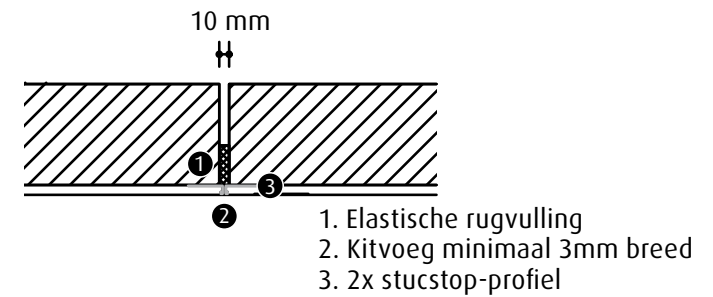

Afwerking koude dilatatie met stucstop-profiel

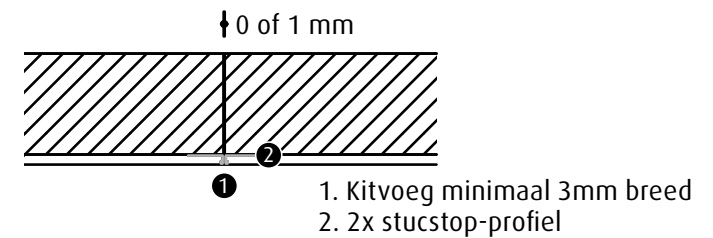

Afwerking koude dilatatie met geperforeerd weefsel

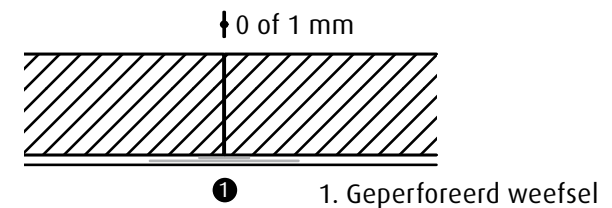

min. 150 mm

Spanningsverdelende laag
verwerken in afwerklaag



Details wandaansluitingen kalkzandsteenwanden

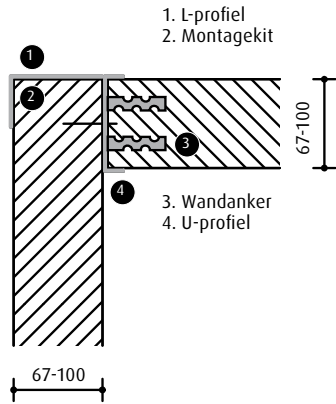

Hoekaansluiting

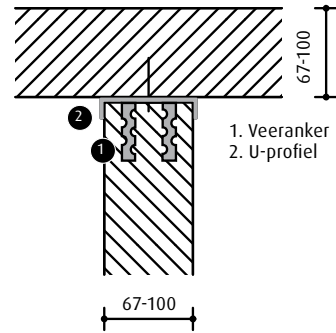

T-aansluiting

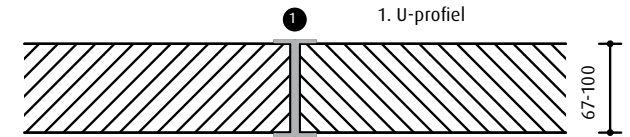
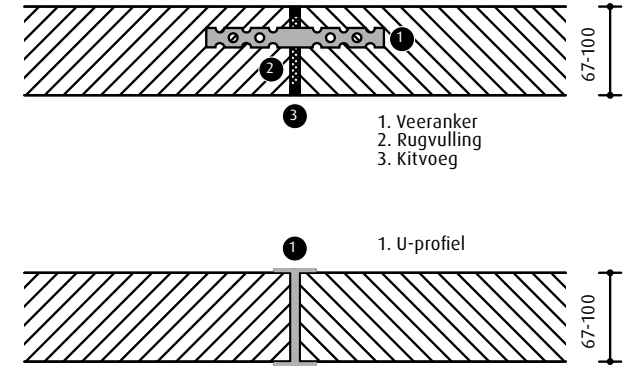
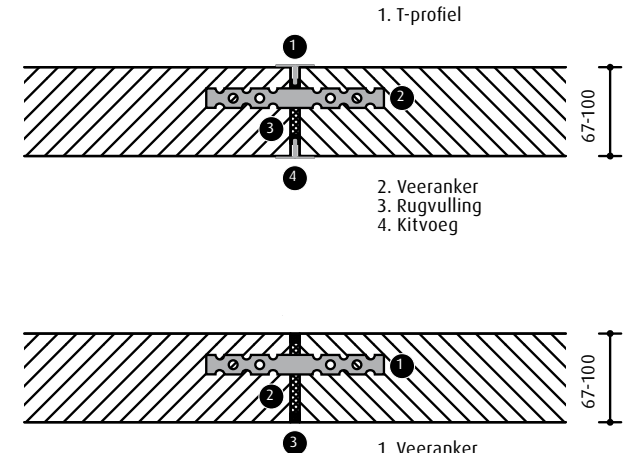

Dilatatie-mogelijkheden

Aansluitingen lijmblokken met kunststofprofielen

Hoekoplossingen vellingblokken
met pastukken gezaagd in het werk voor diktematen van 67 en 100 mm

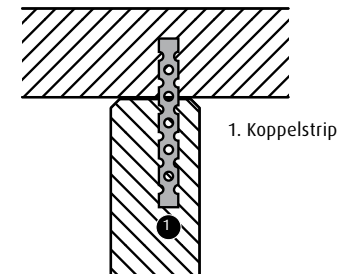
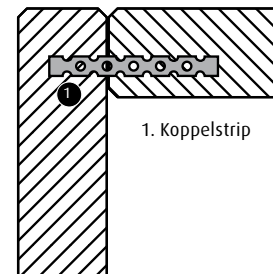
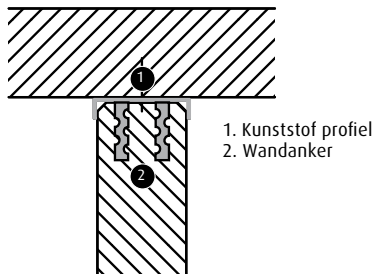
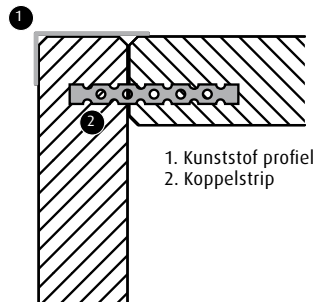



Plafondaansluitingen

Betonvloer

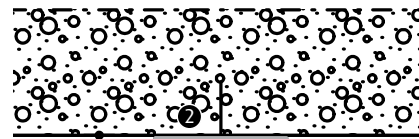

20 mm

1. Kunststof, aluminium of corrosiewerend behandeld stalen U-profiel
2. Montagekit
3. Minerale wol of schuimband met gesloten celstructuur

Betonvloer

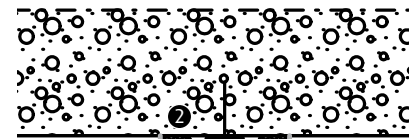

1. Gaasband 50 mm
2. Elastische rugvulling
3. Veeranker

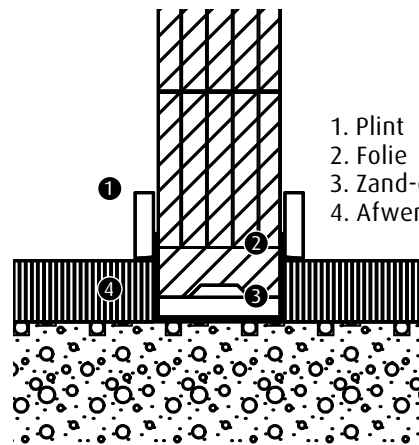

1. Plint
2. Folie
3. Zand-cement-kalkspecie
4. Afwerkvloer

Betonvloer

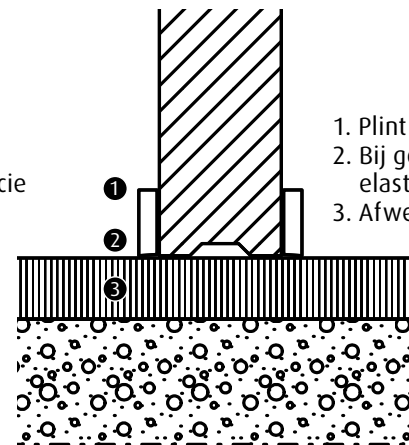

1. Plint
2. Bij geluidseisen kit of elastische voegband
3. Afwerkvloer

Betonvloer

Vloeraansluitingen

Wandaansluitingen

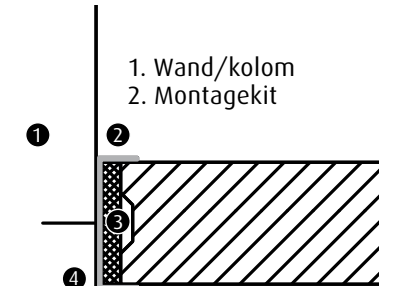

1. Wand/kolom
2. Montagekit

3. Minerale wol of schuimband met gesloten celstructuur
4. Kunststof, aluminium of corrosiewerend behandeld stalen U-profiel

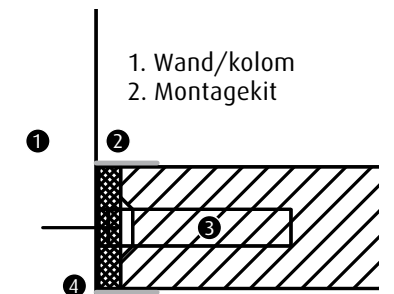

1. Wand/kolom
2. Montagekit

3. Verend anker h.o.h. 600 mm
4. Gaasband 50 mm

> 10 mm